 sunvibessup  sun vibes SUP

www.sunvibessup.com



STAND-UP PADDLE BOARDS



USER GUIDE

USER GUIDE



1. Package Includes:

Inflatable SUP x1;
Adjustable sup paddle x1;
Removable center fin x1;
Removable side fins x2;
High pressure double action pump x1;
Repair kit (PVC+glue+wrench) x1;
Backpack x1; User Manual x1;
Coil leash x1;

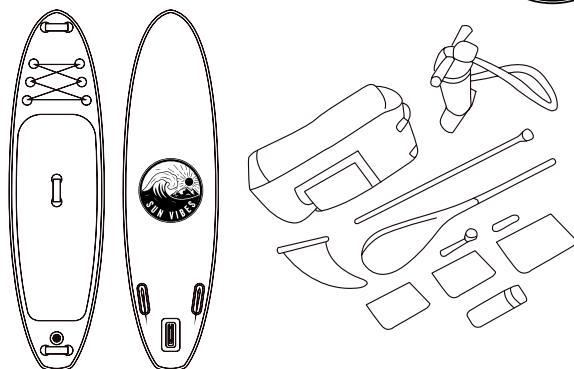

2. Warm Reminder:

Along-lasting SUP needs your careful care, tips below worth your attention:

1. PSI between 15 and 18 PSI (please pay more attention to the pressure when using the electric pump, do not overinflate).
2. Pump using instruction: the side marked with "OUT" is for inflation, other side marked with "IN" is for deflation, which can extract the air out quickly (only when the pressure reaches to certain amount of PSI will the pressure gauge perceive it and push the pointer to move/spin, normally 5PSI.)
3. Avoid long time constant overexposure to the sun to protect the sup board from warping.
4. Trim your dog's nails or put a traction pad on if he stands in front of the SUP paddle board to avoid scratches.
5. Storage: rinse your board with fresh water, dry completely, fins off, store deflated and out of sun.

3. Inflation & Fin Installation:

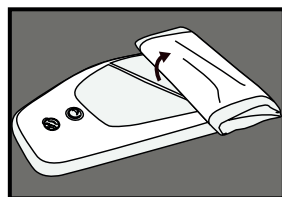

3-1 Unroll

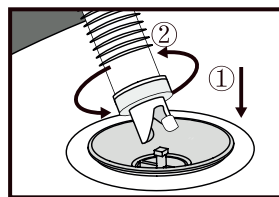

3-2 Pump connection

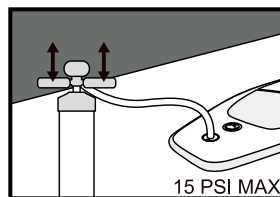

3-3 Inflation

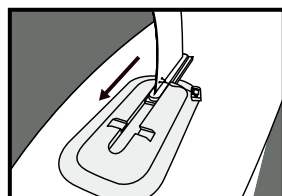

3-4 Install the fins

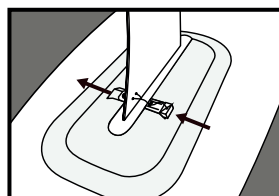

3-5 Fixed the fins

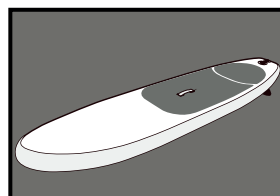

3-6 Finish

4. Deflation & Fin Removal:

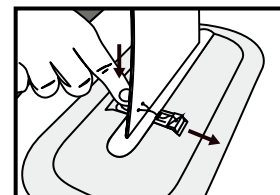

4-1 Drag out the clip

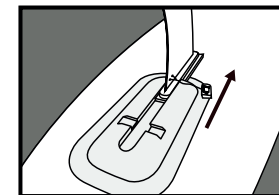

4-2 Remove the fins

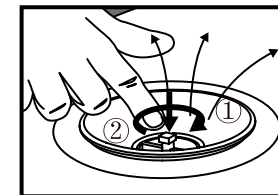

4-3 Press to deflation

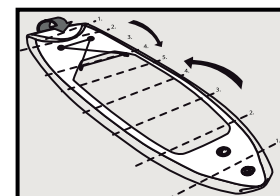

4-4 Roll up

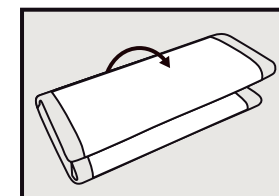

4-5 Finish

5. Valve & Fin Introduction:

The plastic nib in lower position is for deflation, keep in the upper position is for inflation as well as avoid air-leak, please see the diagrammatic illustration on the right.

Cases need your attention:

1. When there is air-leak from the valve or if the air can not be inflated into the SUP, please check the position of the plastic nib first, keep it in the upper position. If it's ok, please follow case 2.
2. The valve may sometimes loosen, please use the wrench (repair kit) to tighten it.
3. If the valve is broken, you can also use the wrench to replace it. See details from below diagram.

